



Laton Road, Hastings TN34 2ET

Offers in excess of £117,000



A bright and spacious STUDIO APARTMENT positioned on the FIRST FLOOR of this attractive period residence located in a sought after, tree lined Road. It's ideally positioned within walking distance of Alexandra Park, good transport links and within easy reach of Hastings Town centre. Presented to a high standard throughout, the accommodation here is arranged as an OPEN PLAN LIVING SPACE which measures 17'4 x 12'1. There is a separate kitchen fitted with CONTEMPORARY UNITS which is positioned at the rear of the property, together with a modern shower room. Being sold with a LONG LEASE this fantastic property would make the perfect first time home or investment.

GROUND FLOOR  
318 sq.ft. (29.5 sq.m.) approx.

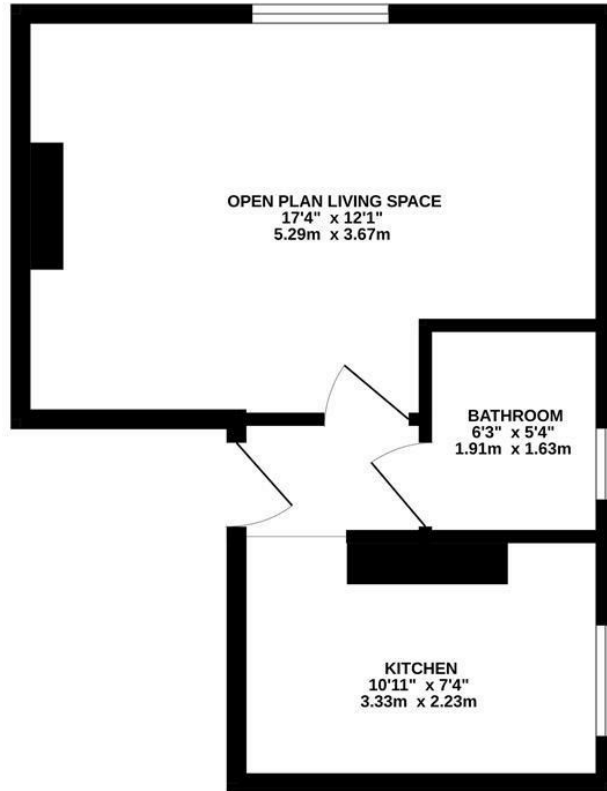

TOTAL FLOOR AREA : 318 sq.ft. (29.5 sq.m.) approx.

Whilst every attempt has been made to ensure the accuracy of the floorplan contained here, measurements of doors, windows, rooms and any other items are approximate and no responsibility is taken for any error, omission or mis-statement. This plan is for illustrative purposes only and should be used as such by any prospective purchaser. The services, systems and appliances shown have not been tested and no guarantee as to their operability or efficiency can be given.

Made with Metropix ©2025

